

# Add on Pockets – Hermione Granger Style Bag



Finished size: Pocket with hook & loop tape closure -  $6 \frac{1}{2}'' \times 3 \frac{1}{4}''$   
Pocket with zipper closure -  $7'' \times 3 \frac{1}{2}''$

Read all of the instructions before you begin.

All seam allowances are  $\frac{1}{4}''$  (6mm) unless otherwise stated.

A 1" button is needed for the bag. Stitch the button by hand to the lining of the bag, just under the casing, in between the handles. If a much bigger pocket is needed, consider making a bigger bag. A pocket that is too big will change the shape of the bag when the bag is closed.

Do not iron directly on satin and velvet, use an iron cloth and low heat.

## Pocket with hook & loop tape closure:

### Supplies:

- 2 pieces -  $8'' \times 7''$  one of outer fabric and one of lining fabric
- 1 piece -  $7 \frac{1}{2}'' \times 6 \frac{1}{2}''$  of iron on interfacing
- 3" hook & loop tape, about  $\frac{1}{2}''$  wide
- 3" thin elastic
- Sewing machine and general sewing supplies

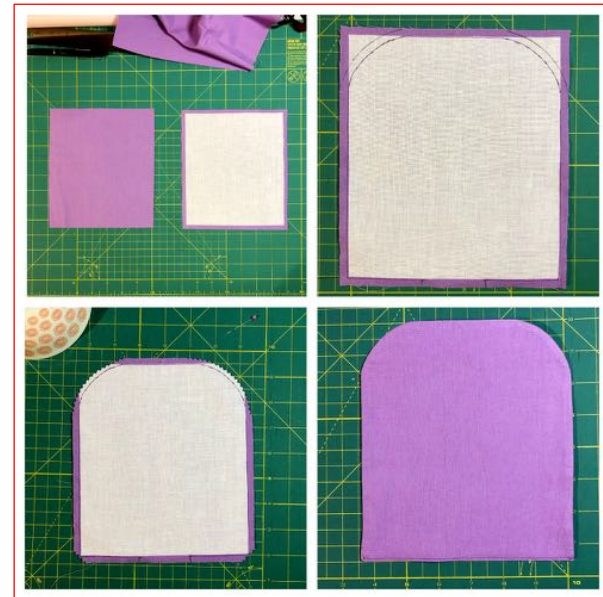

## Annika's Sewing Corner

Iron on the interfacing to the back of the outer fabric piece. In this example it is the same fabric for outer fabric and lining.

Round the corners on the interfacing side with the help of a glass/bowl, roughly 3" in diameter. Draw both the cutting and sewing line but don't cut it until after sewing the pieces together.

Sew the pieces with right sides together, leaving a 3" opening in the short straight edge. Cut off the rounded corners and bottom corners with pinking shears or make small triangle cuts in the seam allowance along the rounded corners, to avoid bulk. Make sure to not cut the stitching.

Turn the right side out through the opening and push out all the seams and corners. Fold in the seam allowance in the opening and press. Top stitch that edge.



Sew the soft piece of the hook & loop tape along the bottom edge of the outside fabric.

## Annika's Sewing Corner

Sew the other piece of the hook & loop tape along the top edge with rounded corners on the lining side.

Fold 3" from the bottom edge with lining sides together and pin in place. Top stitch close to the edge, from one bottom corner to the other along the sides and top edge.



Fold the elastic in half and pin it to the back of the pocket, with the raw edges of the elastic, 1 ½" from the top, centred. Stitch several times over the raw edges to secure the loop. Make sure you only stitch through the back of the pouch.

### Pocket with zipper closure:

#### Supplies:

- 4 pieces - 4" x 7 ½" - two of outer fabric, two of lining fabric
- 1 zipper, 7" or longer
- 3" thin elastic
- Sewing machine with zipper foot and general sewing supplies



Cut one outer piece and one lining piece lengthwise, according to instructions above.

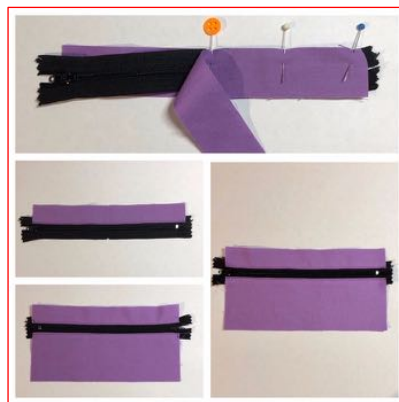

Sandwich the zipper in between the two  $1 \frac{1}{4}'' \times 7 \frac{1}{2}''$  pieces, right sides together with the outer fabric facing the front of the zipper. The long edges should be even with the zipper tape. Stitch with a  $\frac{1}{4}''$  seam allowance and fold the fabric away from the zipper. Top stitch close to the edge to keep the fabric out of the way of the zipper. Repeat for the bottom edge of the zipper with the  $2 \frac{3}{4}'' \times 7 \frac{1}{2}''$  pieces.

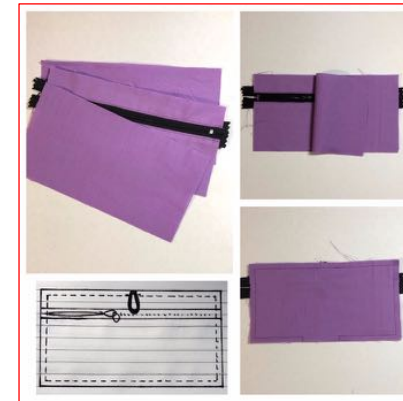

Place the uncut lining piece right sides together with the lining side of the front/zipper panel and baste together. By basting these two layers together first it will be easier to turn to the right side later. Baste the elastic hoop to the front of the zipper panel, see drawing above for placement.

Pull zipper pull away from edge and place the uncut piece of outer fabric right sides together with zipper panel. Stitch all the way around, through all layers, leaving a 3" opening for turning. Cut off the zipper ends and the corners. Turn to the right side through the opening and push out all the corners and seams. Press and hand stitch the opening closed.

